



## Sketch board / Drawing Board alternative for Samsung Galaxy Tab S8/S9 Ultra (14.6")



TheGreatSage

[VIEW IN BROWSER](#)

updated 6. 8. 2024 | published 6. 8. 2024

## Summary

This is an alternative to a Sketch board / Drawing Board for the Samsung Galaxy Tab S8/S9 Ultra (14.6").

[Gadgets](#) > [Portable Devices](#)

Tags: [art](#) [board](#) [tablet](#) [arttools](#) [samsungtablet](#)  
[tabletcase](#) [digitalart](#)

## Introduction

Hello! This is my first time working on a project like this, so please bear with me if I make a few mistakes. I use a Samsung Galaxy Tab S8 Ultra as my main digital drawing device and couldn't find a suitable Sketchboard or Drawing board for my device online, so I decided to create one myself.

Inspired by @Aaaahron\_244508 board(<https://www.printables.com/model/163934-ipad-pro-129-drawing-board>) and @MustafaAl\_1315395 (<https://www.printables.com/model/928858-sketching-board-for-ipad-pro-129-6th->

**generation)** sketching board, I used Fusion 360, took measurements from my tablet, and started designing. This is a large print, so you'll need a lot of time and filament!

## **Printer Settings**

**Layer height:** 0.2mm

**Infill:** 15%

**Supports:** None (depends on orientation but shouldn't be needed)

**Wall loops:** 3

**Material:** eSun PLA+ fire truck red, eSun PLA Matte black

**Print time:** Approximately 30 hours

**Printer:** Bambu Lab P1S

## **Assembly Information**

The pen holder was designed with the Wacom One dimensions as that is my main digital pen. I have created three models:

### **Whole Model**

**A model split into eight separate pieces**

**Another split model with 5mm x 20mm dowel holes along each piece**

**All models have four M20x2.5 thread holes for the stand with two corresponding threads (one 30mm and one 20mm). I am still refining the smoothness of the thread inserts, so I recommend printing bolts at 95%-97% scale for a better fit. I will fix this thread issue soon.**

**The split models are named as follows:**

**LUC (Left Upper Corner)**

**UML (Upper Middle Left)**

**UMR (Upper Middle Right)**

**RUC (Right Upper Corner)**

**LLC (Left Lower Corner)**

**LML (Lower Middle Left)**

**LMR (Lower Middle Right)**

## **RLC (Right Lower Corner)**

### **Optional components:**

**20-30 dowel pins 5mm x 20mm ([https://www.amazon.co.uk/dp/B07MP9X6R3?psc=1&ref=ppx\\_yo2ov\\_dt\\_b\\_product\\_details](https://www.amazon.co.uk/dp/B07MP9X6R3?psc=1&ref=ppx_yo2ov_dt_b_product_details))**

**2 stand legs**

**2 bolts (30mm or 20mm, I would recommend the 30mm)**

**The parts should connect as shown below:**

+---+---+---+---+  
| LUC | UML | UMR | RUC |

+---+---+---+---+  
| LLC | LML | LMR | RLC |

+---+---+---+---+

### **Dimensions**

**Width: 600.36mm**

**Length: 387.505mm**

**Depth: 20mm**

**Stand angle: Approximately 30 degrees**

### **Conclusion**

**If I were to build this again, I wouldn't use as many pins and less holes. Three per side were too many; one or two would suffice. You could also just glue it together but that may be less stable(I tried this on my first print and it broke).**

**Note: This was designed for the Tab S8 Ultra, but from what I've seen online, the dimensions are the same for the Tab S9 Ultra.**

### **Coming Soon**

- **Improved bolt thread fitting for stand legs**
- **Additional suggestions and improvements (still a work in progress)**

**Hope that covers anything. As this is my first model, I appreciate any feedback, questions, or comments, whether positive or negative. Happy printing!**

**EDIT(29/07/2024)**

**I have added the below:**





- **TPU inserts for a better fit and to prevent scratches on the tablet, I split the model using a dovetail cut via bambu slicer, I have also put in the hole model so you can split it how you like (please see added pictures)**
- **Clip holder attachment for keeping charging cable in place (please see added pictures))**

**EDIT(07/08/2024)**

**I have added the below:**

- **40 degree stand for a better drawing angle added as Stand\_Leg\_40, I also find that printing the bolt at 95% with 3 walls, makes it a cleaner and stronger fit for the leg stands. Working on designing new bolt to better fit the thread holes,, so scaling wont be necessary.**

## Model files

<< TPU insert + cable clip		7 files
	tpu_split_cable_end.stl	
	tpu_split_lefthalf.stl	
	tpu_split_righthalf.stl	
	tpu_insert_hole_model.stl	



**pen\_tpu\_insert.stl**



**cabile-clip.3mf**

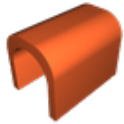

**cabile\_clip.stl**



## **Splited Models**

**36 files**

**andriod-sketchpadwithholes.step**

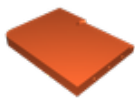

**luc\_with\_holes.stl**



**llc\_with\_holes.stl**



**ruc\_with\_holes.stl**



**umr\_with\_holes.stl**



**lml\_with\_holes.stl**

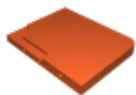

**rlc\_with\_holes.stl**

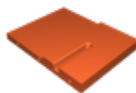

**lmr\_with\_holes.stl**



**uml\_with\_holes.stl**



**uml\_with\_hole.3mf**



**ruc\_with\_hole.3mf**

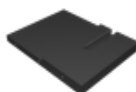

**lml\_with\_hole.3mf**



**llc\_with\_hole.3mf**



**luc\_with\_hole.3mf**

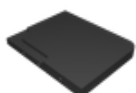

**rlc\_with\_hole.3mf**



**umr\_with\_hole.3mf**

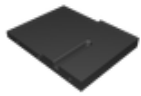

**lmr\_with\_hole.3mf**

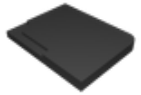

**rlc\_no\_hole.3mf**



**umr\_no\_hole.3mf**



**uml\_no\_hole.3mf**



**llc\_no\_hole.3mf**



**lml\_no\_hole.3mf**

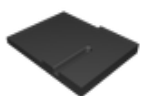

**lmr\_no\_hole.3mf**



**ruc\_no\_hole.3mf**



**luc\_no\_hole.3mf**

**andriod-sketchpadwithholes.f3d**

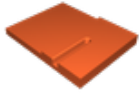

**lmr\_no\_hole.stl**

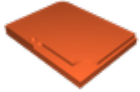

**ruc\_no\_hole.stl**



**lml\_no\_hole.stl**

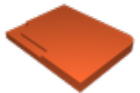

**rlc\_no\_hole.stl**



**uml\_no\_hole.stl**



**luc\_no\_hole.stl**

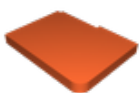

**llc\_no\_hole.stl**



**umr\_no\_hole.stl**

**andriod-sketchpadnohole.f3d**

**andriod-sketchpadnohole.step**





## Whole Model

4 files



**andriod-sketchboard.3mf**



**andriod-sketchboard.stl**

**andriod-sketchpad.f3d**

**andriod-sketchpad.step**



## Accesories

8 files



**20mm\_bolt.3mf**



**30mm\_bolt.3mf**



**stand\_leg.3mf**



**stand\_leg.stl**



30mm\_bolt.stl



20mm\_bolt.stl



stand\_leg\_40.3mf



stand\_leg\_40.stl

## License

This work is licensed under a  
**Creative Commons (4.0 International License)**



**Attribution—Noncommercial—Share Alike**

- ✗ | Sharing without **ATTRIBUTION**
- ✓ | **Remix Culture** allowed
- ✗ | **Commercial Use**
- ✗ | **Free Cultural Works**
- ✗ | **Meets Open Definition**