



## Mini modular toothbrush holder with cover/ Držiak zubnej kefky



Martin Š.

[VIEW IN BROWSER](#)

updated 8. 8. 2024 | published 8. 8. 2024

## Summary

Mini toothbrush holder, small, quickly printable, modular

[Household](#) > [Bathroom](#)

Tags: [holder](#) [mini](#) [print](#) [modular](#) [easy](#) [toothbrush](#) [to](#)  
[držiak](#) [kefka](#)

Hello, I've been looking for a suitable and compact toothbrush holder for a long time, but I couldn't find it, so I created it, I hope you like it.

I recommend mounting to the wall with a double-sided tape or a screw with a model intended for this.

Zdravím vás , dlho som hľadal vhodný a kompaktný držiak zubnej kefky, keďže som ho nenašiel , tak som ho vytvoril, snád' sa vám bude páčiť.

Montáž k stene doporučujem obojstrannou páskou, alebo skrutkou s na to určeným modelom.

### Print Settings

- 0.2 mm layer height ,line width of 0.4mm

- **3 perimeters**
- **20% cubic infill**
- **4 Top and 4 Bottom layers**
- **support is needed**

## Filaments

- **PETG**
- **PLA**

## Model files



**holder-basic-model.stl**

---



**holder-base-model-with-screw-hole.stl**

---



**holder-with-cover-preparation.stl**

---



**holder-with-screw-hole-cover-preparation.stl**

---

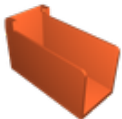

**cover.stl**

---



**screw-cover.stl**

---



clutch.stl

## License $\Theta$

This work is licensed under a  
**Creative Commons (4.0 International License)**



Attribution-NonCommercial

- 
- ✗ | Sharing without **ATTRIBUTION**
  - ✓ | **Remix Culture** allowed
  - ✗ | **Commercial Use**
  - ✗ | **Free Cultural Works**
  - ✗ | **Meets Open Definition**