



Soda Can Opener V2



AbenAlbert

[VIEW IN BROWSER](#)

updated 21. 8. 2024 | published 21. 8. 2024

Summary

Perfect to crack open a cold one on a hot summer day!

[Healthcare](#) > [Home Medical Tools](#)

Tags: [opener](#) [helper](#) [helpful](#) [useful](#) [nail](#) [useful3dprints](#)
[sodacan](#) [sodacancover](#) [sodacanopener](#)

Why I Designed It

designed this model for those with long nails, but it's also a must-have for anyone with arthritis or dexterity issues. It also covers your drink to keep those pesky bees away!

Plus, it's ideal for enjoying a spicy summer drink while camping! 😊

Printing Instructions

The models have been tested with these settings and they are recommended.

- **Orientation:** Print flat with no supports.
- **Nozzle Size:** 0.4 mm.
- **Layer Height:** 1.5 mm.
- **Infill:** At least 50% for maximum sturdiness.

- **Material:** Printed with PLA, but other filaments should work just as well.

After printing

After its done printing, you take it off the build plate, slide the model on the soda can tap, and then simply push up to open the soda can.

Model files



Short version

2 files

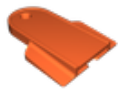

soda-can-opener-short.stl



soda-can-opener-short.3mf



Long version

2 files



soda-can-opener-long.stl



soda-can-opener-long.3mf

License ©

This work is licensed under a
Creative Commons (4.0 International License)



Attribution—Noncommercial—No Derivatives

- ✗ | Sharing without ATTRIBUTION
- ✗ | Remix Culture allowed
- ✗ | Commercial Use
- ✗ | Free Cultural Works
- ✗ | Meets Open Definition