



## K1C-A Serries

 Paul

[VIEW IN BROWSER](#)

updated 26. 7. 2024 | published 26. 7. 2024

### Summary

My stock filament runout sensor needed a bit more space than earlier versions so mad longer model to accommodate

---

[3D Printers](#) > [Creality Parts & Upgrades](#)

---

Creality K1C. Same print info as the other ones. Just longer

### This remix is based on



**Creality K1/K1C runout censor side mount**  
by Baldrik

### Model files

sidebodenmount-v11.stl

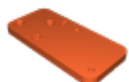

# License $\Theta$

This work is licensed under a  
**Creative Commons (4.0 International License)**



## **Attribution-NonCommercial**

---

- ✗ | Sharing without ATTRIBUTION
- ✓ | Remix Culture allowed
- ✗ | Commercial Use
- ✗ | Free Cultural Works
- ✗ | Meets Open Definition