



Garage Door Sensor Mount for Hörmann



Clemi

[VIEW IN BROWSER](#)

updated 26. 7. 2024 | published 26. 7. 2024

Summary

Garage Door Sensor Mount

[Household](#) > [Other House Equipment](#)

Tags: [garage](#) [garagedoor](#) [hoermann](#)

A simple mount for attaching a sensor to a Hörmann LPU42 garage door. I used a SonofflDoor Sensor ([amazon](#)) and a Neodymium Magnet ([amazon](#)). It works great.

- SonofflDoor Sensor ([amazon](#))
- Neodymium Magnet ([amazon](#))

Take a look at [my other models](#) and leave a comment with a picture of your print!

Model files

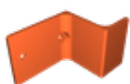

tor-kontakt.stl

License

This work is licensed under a
Creative Commons (4.0 International License)



Attribution—Noncommercial—Share Alike

- ✗ | **Sharing without ATTRIBUTION**
- ✓ | **Remix Culture allowed**
- ✗ | **Commercial Use**
- ✗ | **Free Cultural Works**
- ✗ | **Meets Open Definition**