



# Cthulhu: A Deck Building Game - Insert / Organizer



LeftoverDane

[VIEW IN BROWSER](#)

updated 29. 7. 2024 | published 29. 7. 2024

## Summary

An insert / Organizer for "Cthulhu deck building game" Its made to be used when playing.

[Toys & Games](#) > [Board Games](#)

Tags: [organizer](#) [cthulhu](#) [insert](#) [deck](#)

Ive been playing this game for a while, and founnd out it really needed an insert.

After sleeving the cards, they just dont fit that great in the box anymore.

For some reason, i could only find one insert. and its just not what i was looking for.

So here we have my idea of an insert :P

All parts (Exept the spacers) are ment to be used when playing too.

I made a Flip tray for Minions and Gods, so its easy to flip them out when u need them.

No reason to have all minions out, if u only need one kind

The starter cards allso got a flip tray. Well thats just because it looked better in the box.

Library and Mythos have a deck stand, so they dont fall over when playing. They are tilted 5° back, so they dont slide out of the stand too :)

I recommend printing the Flip tray test.stl to see how the cards fit in the tray, and to see how the hinge work for your printer settings

Both spacers put the infill as low as you dare ;P they are just a spacer with trays, and dont really do any functions that that. so no reason to use too much filament. i used 8% infill on those

the rest i used 15% Grid infill.

Longest stl is 205,3mm and is just a divider with room for dice or other things.

Feel free to donate \\_( )\_/ [paypal.me/LeftoverDane](https://www.paypal.me/LeftoverDane)

## Model files



**flip-tray-test.stl**



**cthulhu-mythos-tray.stl**



**cthulhu-library-tray.stl**



**cthulhu-starter-card-flip-tray.stl**

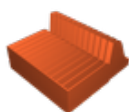

**cthulhu-minion-and-god-flip-tray.stl**

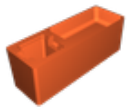

**cthulhu-spacer-tray-1.stl**

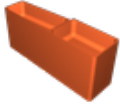

**cthulhu-spacer-tray-2.stl**

## License

This work is licensed under a  
[Creative Commons \(4.0 International License\)](https://creativecommons.org/licenses/by-nc-sa/4.0/)



**Attribution—Noncommercial—Share Alike**

- ✗ | Sharing without ATTRIBUTION
- ✓ | Remix Culture allowed
- ✗ | Commercial Use
- ✗ | Free Cultural Works
- ✗ | Meets Open Definition