



## Charger for Minifinder Nano / Kompy Nano



Bart R

[VIEW IN BROWSER](#)

updated 27. 7. 2024 | published 27. 7. 2024

### Summary

Handy watch stand to charge the Minifinder Nano GPS tracker. Includes cable management and lock-release tool.

[Healthcare](#) > [Medical Tools](#)

Tags: [charger](#) [watch](#) [watchstand](#) [gps](#) [care](#) [elderly](#) [chargerstand](#) [kompy](#) [wuzzi](#) [lifewatcher](#) [watchi](#) [minifinder](#)

### Background

There's a great, reliable GPS tracker that we use quite a lot in handicapped care and elderly care. This device is originally from Minifinder and it's called Minifinder Nano.

There are a lot of third party companies who create their own platform for this device, it's usually for translation, better ease of use or integration with the digital nurse assist systems. One of the most common platform we use in The Netherlands is called Kompy. Others might also know a similar product under the name Lifewatcher, Wuzzi or Watchi. They all use the exact same device from Minifinder. The one big downside of this device, is that you need to attach a magnetic charging cable at the back of the device. Sometimes it just misaligns and it won't charge. Since this

device can literally save the life of a patient, caregivers need to make sure it's always charged. Therefore I designed this watchstand.

Some patients with dementia tend to have the urge to remove the GPS watch. There's an optional wristband lock for that. The manual states that you can open the lock with a screwdriver or a ballpoint pen. I found it easier to just print a custom tool for it. Something tiny that you can always carry with you in your pocket or on a keychain.

**The model explained**

The model consists of 2 main parts and 2 accessories. The 2 main parts need to be assembled, for a bit more security you can add a drop of glue to the connecting parts. Details of the parts:

- The base. On one side it has a place for a nametag (quite handy if you use multiple devices for multiple patients). On the other side there's an engraving of the device name. Along the vertical axis there's a small gutter to run the cable through. Near the bottom there's a slight indent to attach the cable clip, to keep everything tidy.
- The head. You can place the original charger cable inside the head and then run the cable along the gutter on the back. You might need a bit of force to push the magnetic part of the cable in place. That's intentionally to prevent the cable from coming out of the head when the watch is attached. On the bottom of the head there's a small slot. This fits neatly on the base. No support needed for that slot, but for the cable gutter I recommend a bit of support.
- The cable clip. You can attach it near the bottom of the vertical cable gutter. This way you can keep the cable running low. If your power plug is up high, you can leave the cable clip.
- The wristband lock release key. This tool is only needed when you use the wristband lock. You can fit the release tool onto the base, so you won't lose it. You can also keep it on a keychain.

I made this model at my work, together with a few caregivers and patients. I'd love to hear your feedback. If you work with patients who use this specific GPS tracker, feel free to download and print the model. Please do let me know if you're using my design, I love to know if you find it practical and if you have any tips to improve this model. This model is not for commercial use. You may not sell this model or distribute it without my written approval.

# Model files



knano-charger-voet-v28-dieper-slotgatje.stl



knano-charger-kop-v27.stl

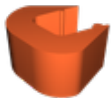

knano-kabelclip-v27.stl



sleutel1-met-gat-en-langere-steel.stl



minifinder-all-object-for-prusa-mini.3mf

## License

This work is licensed under a  
**Creative Commons (4.0 International License)**



**Attribution-NonCommercial**

- ✗ | Sharing without **ATTRIBUTION**
- ✓ | **Remix Culture** allowed
- ✗ | **Commercial Use**
- ✗ | **Free Cultural Works**
- ✗ | **Meets Open Definition**

