

Geared Card Box



Invexpo

[VIEW IN BROWSER](#)

updated 27. 7. 2024 | published 27. 7. 2024

Summary

Read description before printing please :)

[Toys & Games](#) > [Board Games](#)

Tags: [box](#) [card](#) [gear](#) [cardbox](#) [geared](#)

Hello,

I've worked long hours on the model, and I hope you'll like it.

Remember that printers have different tolerances; the main issue is the latch, which is adjusted to the parameters of my printer. However, if you find that one of the latch parts is too loose or won't connect after printing the model, I've prepared an alternative version with different sizes, which I hope will solve the problem.

When assembling the model, don't be afraid to use some force, but remember to prepare one side properly first before pressing in the opposite side. Otherwise, there's a high chance of breaking the parts.

First, fold the box, then open it and insert the folded interior, not the other way around!

Trim well brim around the lock! Otherwise, it will be too tight. I recommend using a knife.

I'm a beginner in 3D printing, so I'm happy to hear any suggestions for changes to the model and will try to implement them. Thank you to everyone who prints and reviews the model. It gives me a lot of motivation to continue working.

Have fun!

CHECK OUT MY OTHER MODELS! :)



1. <https://www.printables.com/pl/model/852471-ring-lamp-with-panels>
2. <https://www.printables.com/pl/model/832459-2-types-present-box-with-lock>

Model files

<< Card Box		9 files
	1.stl	
	2.stl	



3.stl



4-print-x2.stl



5.stl



5-with-the-inscription-cards.stl

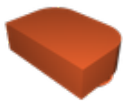

6.stl

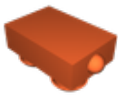

7.stl



8.stl



Replacemenet

4 files



1-narrower.stl

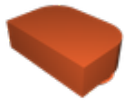

2-narrower.stl

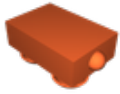

3-narrower.stl



4-wider.stl

License Θ

This work is licensed under a
[Creative Commons \(International License\)](#)



Public Domain

- ✓ | Sharing without ATTRIBUTION
- ✓ | Remix Culture allowed
- ✓ | Commercial Use
- ✓ | Free Cultural Works
- ✓ | Meets Open Definition