



Simple Barista tamping mat

F Florian Masclet

[VIEW IN BROWSER](#)

updated 27. 7. 2024 | published 27. 7. 2024

Summary

A simple and elegant tamping mat for espresso making. Avoid damaging your portafilter and your table!

[Household](#) > [Kitchen](#)

Tags: [espresso](#) [coffee](#) [mat](#) [tamping](#)

Dimensions are 205 x 145 x 45 mm, 4 mm thickness.

I printed this in cr-tpu with a 0,2mm layer, 15% infill setting. It took about 8h on a Prusa MK4 with the original 0,4mm nozzle.

Don't mind the visible artefact on the photo, I paused the printing and messed with the filament a little.

Model files

tapis-barista.stl

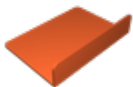

License ©

This work is licensed under a
Creative Commons (4.0 International License)



Attribution-NonCommercial

- ✗ | Sharing without ATTRIBUTION
- ✓ | Remix Culture allowed
- ✗ | Commercial Use
- ✗ | Free Cultural Works
- ✗ | Meets Open Definition