

Filament guide with bearings for Prusa MK3S



GermanDarknes

[VIEW IN BROWSER](#)

updated 17. 12. 2021 | published 17. 12. 2021

Summary

Filament guide with bearings for Prusa MK3S. Used for "side" loading into the extruder.

[3D Printers](#) > [3D Printers - Upgrades](#)

Tags: [prusa](#) [filament](#) [mk3s](#) [filamentguide](#)

Filament guide with bearings for Prusa MK3S. Used for "side" loading into the extruder.

Fits into the default Z-axis holder.

Necessary parts:

- 2x 608 bearings
- M3X30 screw + nut

Support:

- Tower can be printed upside down, no support necessary
- Base, probably needs some support, didn't try without

Model files

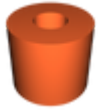

bearing_nut.stl



roll.stl



tower.stl

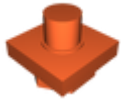

base.stl

License ©



This work is licensed under a
[Creative Commons \(4.0 International License\)](#)

Attribution—Noncommercial—Share Alike

- ✗ | Sharing without ATTRIBUTION
- ✓ | Remix Culture allowed
- ✗ | Commercial Use
- ✗ | Free Cultural Works
- ✗ | Meets Open Definition