



Creality K1 Enclosed Hinged Lid Raiser



PropTroniX

[VIEW IN BROWSER](#)

updated 27. 7. 2024 | published 27. 7. 2024

Summary

Keeps the K1 enclosed for printing with ABS, ASA etc. Options for Side Mount or Rear Mount Filament Sensor.

[3D Printers](#) > [Creality Parts & Upgrades](#)

Tags: [lid](#) [creality](#) [raiser](#) [enclosed](#) [k1](#)

Lid raiser for the Creality K1.

Features:

Has a Bubble for the Cable Chain to move into when printing on the left side of the build plate.

Hinges so the lid can be opened for printing PLA etc.

Handle for living the K1 Lid

Extended right hinge to cover gap in lid (Side mounted Filament Sensor Only)

Back plate's for both side mount and rear mount Filament Sensor.

10mm Wide x 1 or 2mm thick foam tape can be used around the edge to dampen the noise when the lid is closed.

Model files



k1_lid_raiser_whole-v1.stl



front_left_corner.stl



back_panel_side_mount_sensor.stl



front_panel_k1_insert.stl



back_right_corner_side_mount_sensor.stl

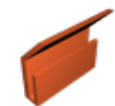

left_hinge.stl

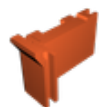

back_left_corner.stl



front_panel_white_plate.stl

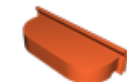

left_speed_bump_panel.stl



lid_handle.stl



right_hinge_pin.stl



right_hinge_side_mount_sensor.stl



front_panel.stl



front_right_corner.stl

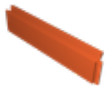

right_panel.stl

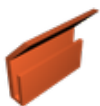

right_hinge_rear_mount_sensor.stl



left_hinge_pin.stl

License

This work is licensed under a
GNU



- ✖ | Sharing without ATTRIBUTION
- ✓ | Remix Culture allowed
- ✓ | Commercial Use
- ✓ | Meets Open Definition
- i | Share under the same license