



2020 Mount - Open End, Open Side, Less Material

 spyder6346

[VIEW IN BROWSER](#)

updated 27. 7. 2024 | published 27. 7. 2024

Summary

Mount to put 2020 extrusions on the top of printer, with open end and open sides

[3D Printers](#) > [Voron Parts & Upgrades](#)

Tags: [voron](#) [ercf](#) [tradrack](#) [filamentalist](#)

This remix is based on



BYOLE Open-Face 2020 Mount for Voron
by Chuifune

Model files

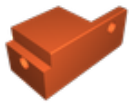

2020mount_mod_rev3.stl

License

This work is licensed under a
Creative Commons (4.0 International License)



Attribution-ShareAlike

-
- ✗ | Sharing without **ATtribution**
 - ✓ | Remix Culture allowed
 - ✓ | Commercial Use
 - ✓ | Free Cultural Works
 - ✓ | Meets Open Definition