

Taj Mahal



FallenAngel

[VIEW IN BROWSER](#)

updated 5. 8. 2024 | published 5. 8. 2024

Summary

Taj Mahal

[World & Scans](#) > [Historical Context](#)

Tags: [educational](#) [architecture](#) [historical](#) [homedecor](#)
[homedecoration](#) [tajmahal](#)

A 3D printed Taj Mahal model captures the intricate details of the dome, minarets, and arches, showcasing the architectural beauty and historical significance of this iconic monument in a compact form.

Includes precise slots for 5mm diameter, 2mm thickness magnets

Model files



la01_01a_a000_tajmahal_base_v1.stl



la01_01a_a002_tajmahal_bottom_v1.stl



la01_01a_a004_tajmahal_smalldome_v1.stl

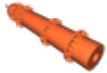

la01_01a_a005_tajmahal_tower_v1.stl



la01_01a_a003_tajmahal_centerdome_v1.stl

License

This work is licensed under a
Creative Commons (4.0 International License)



Attribution

- ✗ | Sharing without **ATtribution**
- ✓ | Remix Culture allowed
- ✓ | Commercial Use
- ✓ | Free Cultural Works
- ✓ | Meets Open Definition