



RC Raceboat Mini Basher 450 Stand

B

Bash_Tech

VIEW IN BROWSER

updated 5. 8. 2024 | published 5. 8. 2024

Summary

Very fast RC Mono Race boat. Fully 3d printed. Easy to print, easy to assemble

[Hobby & Makers](#) > [RC & Robotics](#)

Tags: [rc](#) [boat](#)

Get the STLs here: <https://cults3d.com/:2176763>

Very fast RC Mono Race boat. Fully 3d printed. Easy to print, easy to assemble.

A 3d printable Propeller is also included.

The boat handles quite agile. It has self-rightening in case you flip it over. There is a seal integrated for easy open and close with a single thumbscrew.

First speed tests were about 50-60 km/h

You can build the boat well under 100€.

I made a detailed build guide, including the bill of materials

https://drive.google.com/file/d/1H91f-3cMxojEyr9z8fsSW_c0ubl6XaRQ/view?usp=sharing

Build guide video

<https://youtu.be/fOWdJexgfUM>

Drive video
Coming soon

Technical data:

Length: 560 mm

Width: 138 mm

Weight: ~850g (take-off weight)

Battery: 3s LiPo up to 2200mAh

Motor: 2940 water-cooled

Power: ~800W or even more if you dare 😊

ESC: ~ 60 Amp

Needed filament: ~750g PLA. + 50g PETG or ABS for Motor mount

Needed printer size: 180x180x180mm

Instagram:

https://www.instagram.com/bash_tech_

Also check out my other creations.

If you have any questions, feel free to ask. I'm quite active here.

Model files

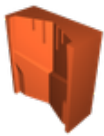

stand_5_infill.stl

License ©



This work is licensed under a

[Creative Commons \(4.0 International License\)](https://creativecommons.org/licenses/by-nc/4.0/)

Attribution-NonCommercial

-
- ✗ | Sharing without ATTRIBUTION
 - ✓ | Remix Culture allowed
 - ✗ | Commercial Use
 - ✗ | Free Cultural Works
 - ✗ | Meets Open Definition

