



# Lithophane Christmas Ball Harley Davidson



ORDEEP

[VIEW IN BROWSER](#)

updated 18. 12. 2021 | published 18. 12. 2021

## Summary

Lithophane Christmas Ball



6.37 hrs



1 pcs



0.25 mm



0.40 mm



PLA



61 g



Prusa  
MK3/S/S+

[Seasonal designs](#) > [Winter & Christmas & New Year's](#)

Tags: [lithophane](#) [christmas](#) [ball](#) [ornaments](#)

[christmasdecoration](#)

[christmasornaments](#)

[xmastreeornaments](#)

Lithophane Christmas ball mad on:

<https://tool.itslitho.com/CreateModel>

Settings of the Lithophane in the images.

- PLA
- 0.4mm nozzle
- 0.25mm layer height
- Stock prusaslicer settings
- 100% infill
- Support Enforcers Only

## Model files

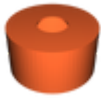

**lithophane-christmas-ball-cap.stl**



**lithophane\_christmas\_ball\_harley\_davidson.stl**



**lithophane\_christmas\_ball\_harley\_davidson.3mf**

## Print files



**harley\_davidson\_025mm\_pla\_mk3s\_6h22m.gcode**

🌀 PLA 📏 0.40 mm ⚖️ 0.25 mm ⌚ 6.37 hrs ⚖️ 61 g 🖨️ Prusa MK3/S/S+

## License ©



This work is licensed under a  
[Creative Commons \(International License\)](#)

**Public Domain**

- 
- ✓ | Sharing without ATTRIBUTION
  - ✓ | Remix Culture allowed
  - ✓ | Commercial Use
  - ✓ | Free Cultural Works
  - ✓ | Meets Open Definition