

Sprung Flexicoil Side Frames and Mounting Bracket for USA Trains R22-115 Motor Block

R Roger

[VIEW IN BROWSER](#)

updated 14. 8. 2024 | published 14. 8. 2024

Summary

I modified the existing design to fit a USA Trains R22-115 motor block. I also modified to accept real springs.

[Toys & Games](#) > [Outdoor Toys](#)

I lengthened the existing sideframe to fit a USA Trains R22-115 motor block.

I also removed the plastic springs and added receptacles for real springs.

This remix is based on



EMD Flexicoil sideframes for USA Trains NW2/S4 motor blocks

by Manimal

Model files

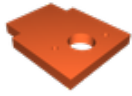

flexicoil-back-cap.stl



flexicoil-cylinder.stl



r22-115-flexicoil-bracket.stl



flexicoil-journal-box.stl



flexicoil-r22-115-sideframe.stl

License

This work is licensed under a
[Creative Commons \(4.0 International License\)](https://creativecommons.org/licenses/by-nc-sa/4.0/)



Attribution—Noncommercial—Share Alike

- ✗ | Sharing without ATTRIBUTION
- ✓ | Remix Culture allowed
- ✗ | Commercial Use
- ✗ | Free Cultural Works
- ✗ | Meets Open Definition

