



Gridfinity - Bathroom Organization



Henry

[VIEW IN BROWSER](#)

updated 6. 8. 2024 | published 6. 8. 2024

Summary

Customized gridfinity bins for organizing a bathroom

[Household](#) > [Bathroom](#)

Tags: [wet](#) [razor](#) [soap](#) [organize](#) [de](#) [shave](#) [floss](#)
[conditioner](#) [stirling](#) [nivea](#) [gridfinity](#) [wetshave](#)

Customized gridfinity bins for organizing a* bathroom! The bins are on a 21mm grid, compatible with a basic 42mm gridfinity baseplate.

These bins were designed for a 20mm grid, as that fits my bathroom drawers nearly perfectly. I resized everything for 21mm, but have NOT retested everything. The Nivia and Stirling aftershaves are a **little** bit worrisome, but everything else **should** work fine.

Organizing a bathroom, as in mine. Might be nothing of use to you in here!

Model files



21mm-sharps-text.stl

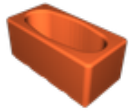

21mm-deoderant-upright.stl

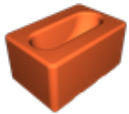

21mm-oral-b-floss.stl

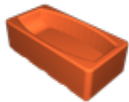

21mm-nivea-upright.stl

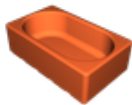

21mm-ogx-conditioner-compact.stl

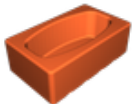

21mm-cetaphil.stl



21mm-sample-puck-loader-body.stl

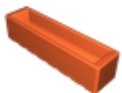

21mm-deoderant.stl



21mm-sample-puck-loader-lid.stl

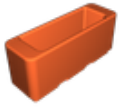

21mm-mach3-refills.stl

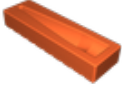

21mm-colgate-toothpaste.stl

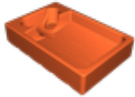

21mm-nivea-flat.stl

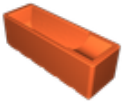

21mm-nivea-side-compact.stl

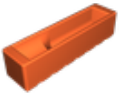

21mm-stirling-aftershave-side-compact.stl

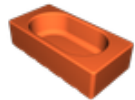

21mm-ogx-conditioner.stl

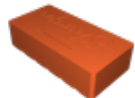

21mm-sharps-body.stl

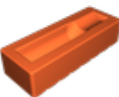

21mm-stirling-aftershave-side.stl

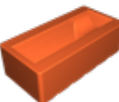

21mm-nivea-side.stl

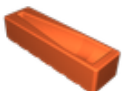

21mm-beebald.stl



21mm-stirling-shave-soap-samples.stl

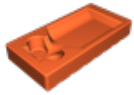

21mm-stirling-aftershave-flat.stl

License

This work is licensed under a
[Creative Commons \(4.0 International License\)](https://creativecommons.org/licenses/by-nc/4.0/)



Attribution-NonCommercial

- ✗ | Sharing without ATTRIBUTION
- ✓ | Remix Culture allowed
- ✗ | Commercial Use
- ✗ | Free Cultural Works
- ✗ | Meets Open Definition