



Storage trays for pliers



Darrens Workshop

[VIEW IN BROWSER](#)

updated 18. 12. 2021 | published 18. 12. 2021

Summary

A range of storage trays for pliers and scissors designed to fit in the draw of a tool trolley.

[Hobby & Makers](#) > [Tools](#)

Designed to fit a KingChrome tool draw, these modular plier trays can be mixed and matched to fit into other draws too.

If you need further customisation, I show you how to design your own in this video.

<https://www.youtube.com/watch?v=MoCnbftsMFc>

Model files



above-vice-grips.stl

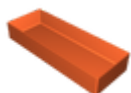

large-snips.stl

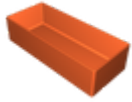

thin-tray.stl

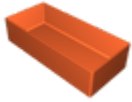

above-pincers.stl

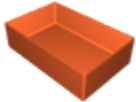

top-tray-1.stl



large-snips-bottom.stl

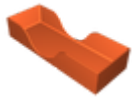

pincers.stl



large-snips-top.stl



side-cutters.stl

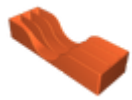

snips.stl

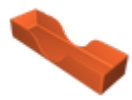

vice-grips.stl

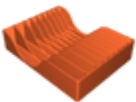

small-vertical-piars.stl

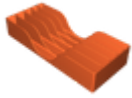

vertical-plier-tray-v2.stl

License ©

This work is licensed under a
[Creative Commons \(4.0 International License\)](#)



Attribution—Noncommercial—No Derivatives

- ✗ | Sharing without ATTRIBUTION
- ✗ | Remix Culture allowed
- ✗ | Commercial Use
- ✗ | Free Cultural Works
- ✗ | Meets Open Definition