



Grumbot from Hermitcraft

 **GHow**

[VIEW IN BROWSER](#)

updated 23. 12. 2022 | published 23. 12. 2022

Summary

This is a model of Grumbot from season 6 of the Hermitcraft multiplayer server for Minecraft.

[Art & Design](#) > [Sculptures](#)

Tags: [minecraft](#) [mumbojumbo](#) [grian](#) [hermitcraft](#)

The model is about 6 inches wide, and 9 inches tall. I would recommend scaling down the faceplate, eyes, and mustache to about 98% so that it can fit in and be removed from the chassis in order to store items inside. If you do not want to use the inside for storage, 100% will work well, albeit a little tight. The screws and receiver also have a tight fit, and scaling them down to 98% as well or slightly less may help on a less calibrated printer. Also, print two eyes, and four screws.

Model files



grumface-v6.stl



grumscrew-v1.stl



reciever-v4.stl

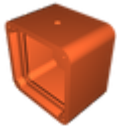

grumbase-v5.stl



grumball-v2.stl



stache-v2.stl

eye-v2.stl

☐ Print two of these!

License

This work is licensed under a
Creative Commons (4.0 International License)



Attribution-ShareAlike

- ✗ | Sharing without ATTRIBUTION
- ✓ | Remix Culture allowed
- ✓ | Commercial Use
- ✓ | Free Cultural Works
- ✓ | Meets Open Definition

