

Resmed Air Sens 10 mask repair



jean-yves carlier

[VIEW IN BROWSER](#)

updated 6. 8. 2024 | published 6. 8. 2024

Summary

Part for repairing the Resmed Air Sens 10 mask when the top of the harness support pads breaks.

[Healthcare](#) > [Home Medical Tools](#)

Print this part in TPU to have flexibility when inserting the harness holder.

Model files

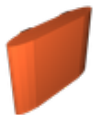

reparation-masque-respirateur-resmed-air-sens-10.stl

License

This work is licensed under a
Creative Commons (4.0 International License)





-
- ✗ | **Sharing without ATTRIBUTION**
 - ✓ | **Remix Culture allowed**
 - ✗ | **Commercial Use**
 - ✗ | **Free Cultural Works**
 - ✗ | **Meets Open Definition**