



900mhz Antenna Splint

 **Lmetlicka**

[VIEW IN BROWSER](#)

updated 6. 8. 2024 | published 6. 8. 2024

Summary

A 'splint' for the ANT-916-CW-HWR-SMA antenna used by many 900mhz devices.

[Hobby & Makers](#) > [Mechanical Parts](#)

Tags: [camera](#) [control](#) [antenna](#) [splint](#) [900mhz](#) [spudnik](#)

The ANT-916-CW-HWR-SMA antenna offers exceptional performance in the US 802.11ah range of 902-928mhz, but the pin that holds the 'elbow' of the antenna together is prone to damage when not used carefully. this antenna splint holds the antenna in either a 0 or 90 degree angle. the splint can be used with antennas where the elbow has been damaged, or it can be used proactively to prevent damage to the antenna.

Model files

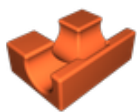

antenna-splint-v10.obj

License Θ

This work is licensed under a
Creative Commons (4.0 International License)



Attribution-NonCommercial

- ✗ | Sharing without ATTRIBUTION
- ✓ | Remix Culture allowed
- ✗ | Commercial Use
- ✗ | Free Cultural Works
- ✗ | Meets Open Definition