



Catan PLUS + Seafarers + Cities & Knights INSERT



CaVe

[VIEW IN BROWSER](#)

updated 7. 8. 2024 | published 7. 8. 2024

Summary

Catan PLUS (2016) insert that includes expansions Seafarers and Cities&Knights, all with 5-6 player expansions

[Toys & Games](#) > [Board Games](#)

Tags: [boardgame](#) [catan](#) [boardgameinserts](#)
[boardgameorganizer](#)

This insert is for Catan PLUS (2016) that includes the 5-6 player expansion, two new maps (in this case are Mallorca and New York, but it depends on the country I think), two mini-expansions “Frenemies” and “Helpers of Catan”.

It also fits the Seafarers expansion (2015) with its 5-6 player expansion and the Cities&Knights (2010) with its 5-6 player expansion.

I have 2 sets of card trays, for easy access to all players, but you can only print one if you wish. This is the original model used <https://www.printables.com/model/362095-catan-card-holder-v1>

Each color has all its components in trays that fit together, but are separated according to the expansion they belong.

Each mini-expansion has its own box storage with all its components .

There are dedicated storage for all mini figures, dice and numbers.

Box has no lid lift, and it could store some other expansion if carefully organized in the box.

Model files



catan_playercomponents.stl

|| Print 1 for each color you have

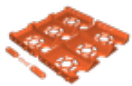

catan_resourcecards.stl

|| x1 for Base Resource, x1 for C&K Resource



catan_basegameck_dicefigs.stl

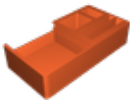

catan_sf_figscards.stl

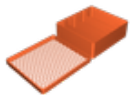

catan_ck_tilescards.stl

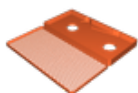

catan_ck_citytiles.stl

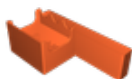

catan_maptiles.stl

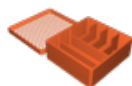

catan_mini-expansions.stl

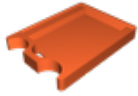

catan_basegame_buildingcostcards.stl

License Θ

This work is licensed under a
[Creative Commons \(4.0 International License\)](#)



Attribution-NonCommercial

- ✗ | Sharing without ATTRIBUTION
- ✓ | Remix Culture allowed
- ✗ | Commercial Use
- ✗ | Free Cultural Works
- ✗ | Meets Open Definition